

INTERLOCKED POWER MODULE

50AMP 240VAC

(50A 240VAC)

Catalog No: R50-240-50-65SC-SP

Item No:1700-39A

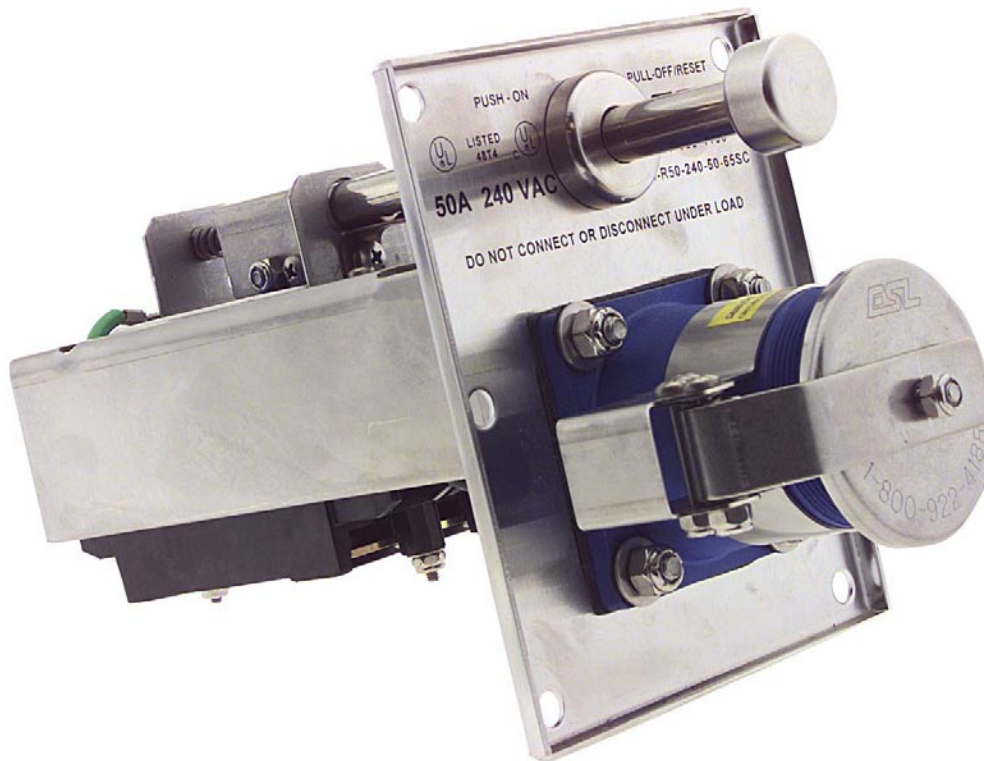

- Heavy Duty Stainless Steel Construction Resists Corrosion & Abuse
- UL Listed Circuit Breaker Protects Operator & Equipment
- Nickel Plated Brass Contacts & Unique Outlet Design Resists Corrosion & Arc Tracking

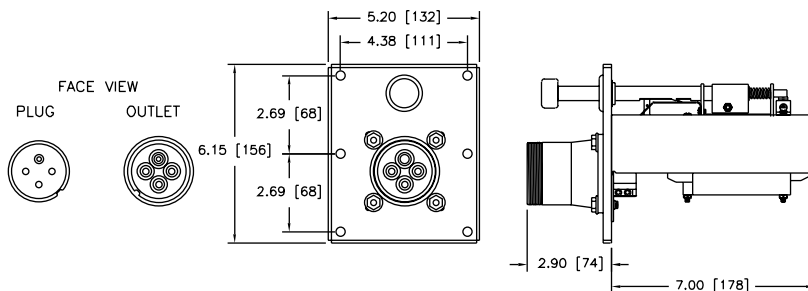

RATING:

- Receptacle - 50A 250VAC (UL1686 Figure C5.1 & ISO 1496-2 Annex N)
- Circuit Breaker - 50A Trip, 65,000AIC @ 240VAC
- Environmental - IP67 per IEC 529 / IEC 309-1
(Screw Cover or Mated Plug) Type 4X capable per NEMA 250, UL 50/508, CSA 22.2
- Terminals - (3) Phase & (1) Ground pressure type screw terminal
Phase: #14 - #6 AWG (2.5-16mm²) Wire Range
Ground: #14 - #6 AWG (2.5-16mm²) Wire Range

MATERIALS:

- Stainless Steel - Frame, On/Off Rod, Interlock Mechanism, Contact Terminal Screws & Spring, Snap Cover, Screw Cover Tether, and all Fasteners
- Nickel Plated Brass - Contact Sleeves
- Thermoplastic Polyester (PET) - Receptacle Housing
- Polyamide (Nylon) - Screw Cover (optional)
- Neoprene (CR) - Gaskets, Cover Seals
- Buna-N (Nitrile/NBR) - O-Rings

APPROVALS:

UL/cUL Listed Module • UL 489 Listed / CSA Certified Molded Case Circuit Breaker

ACCESSORIES / PARTS

| Description | Item No. | Description | Item No. |
|--------------------------------------|----------|-------------------------------|----------|
| • Stainless Steel Snap Cover Assy | 1500-16 | • Circuit Breaker | 4020-06 |
| • Screw Cover & Tether Assy Optional | 1500-05 | • Phase Sleeve Kit (set of 3) | 4015-03 |
| • Receptacle & Contact Assy | 4010-26 | • Ground Sleeve Kit | 4016-08 |

ESL Power Systems, Inc.

2800 Palisades Drive • Corona, CA 92880-9427
 Tel: (951) 739-7020 • (800) 922-4188 • Fax : (951) 739-7048
 www.eslpwr.com • e-mail: info@eslpwr.com

